

Proposed



Mansfield Shire

Emergency Services Precinct

Including Resilience and Recovery Hub

Funding purpose

- ▶ Fit for purpose infrastructure to reduce the vulnerability of the Mansfield Shire community, increase its capacity to respond to and recover from emergency situations and support the growing resident and visitor populations.
- ▶ To construct a Resilience and Recovery Hub within an emergency precinct that co-locates SES, CFA and Ambulance Victoria services and includes Mansfield Community Radio, a licensed emergency broadcaster.
- ▶ The Resilience and Recovery Hub will include training facilities, volunteer support facilities and shared administration.

Extensive consultation has been undertaken and the project enjoys broad support in the community and emergency services sector.



Why this is a priority

- ▶ Mansfield Shire's vast tracts of land, topographic isolation and frequency of natural disasters such as bushfires, storms and floods, provide challenges for visitors and the local community.
- ▶ Co-location of central infrastructure will promote efficiency of emergency response and recovery in Mansfield and is consistent with State Government policies and plans.
- ▶ Modern central facilities will attract volunteers and greater community effort.
- ▶ Mansfield Ambulance Station is one of the lowest performing stations in the State impacted by travel distances, local geography and patient transfers to Wangaratta and Melbourne.

Proposed site

166 Maroondah Highway, Mansfield

The proposed site is in Council ownership with the only current use being Mansfield SES. It is a clear site with broad Maroondah Highway frontage and no existing vegetation.

Total Project Cost: \$7m

Amount required

\$3m Federal funding for the Resilience and Recovery Hub

Project Stages



Why a precinct?

The precinct approach will maximise interaction and integration with Mansfield Resilience Centre facilitating closer partnerships between emergency services agencies and their partners, and supporting programs and activities to increase community resilience and support the valuable work of volunteers.

Next Steps

- ▶ Planning, site investigation and design phase.
 - Planning - finalisation of partnership agreements and operating model
 - Site investigation - traffic management and town planning
 - Design - schematic design for Mansfield Resilience Centre
- ▶ Advocacy for State and Federal funding.

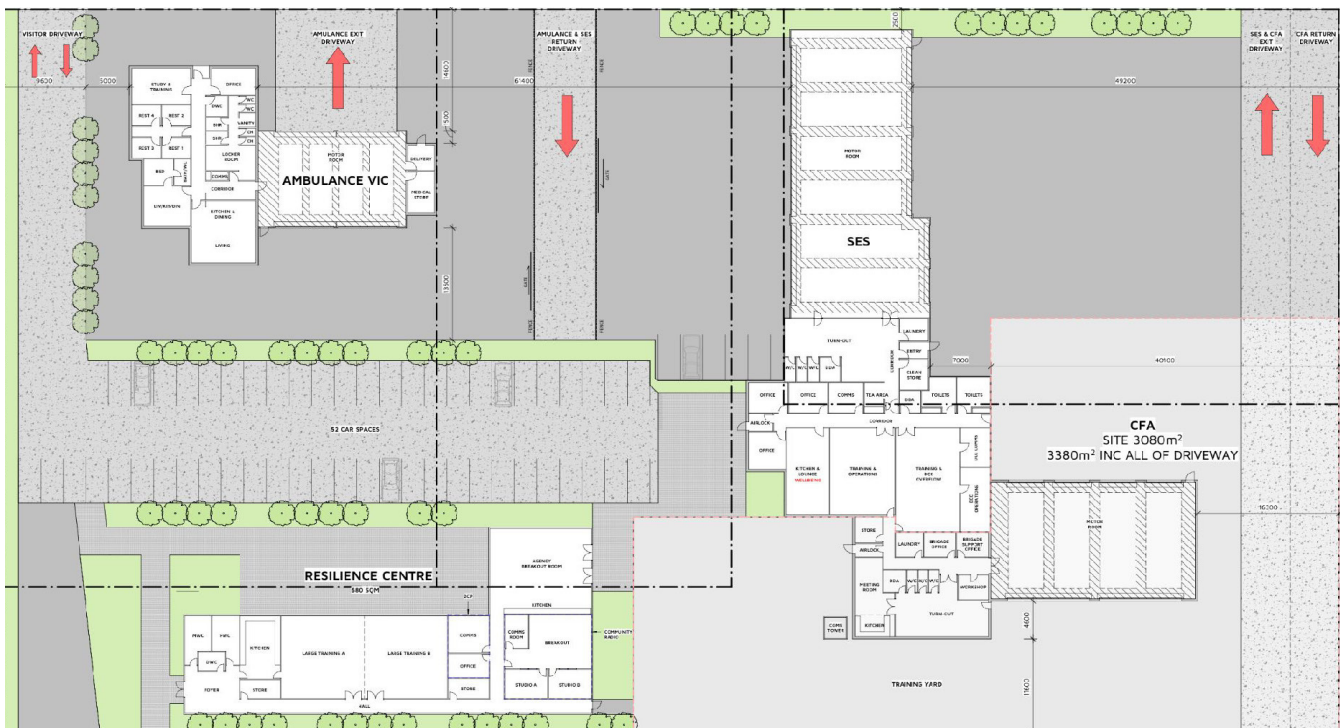

Proposed Mansfield Emergency Services Precinct concept plan.